

Denyo[®]

Engine-Driven Generator

DCA-41ESEK5

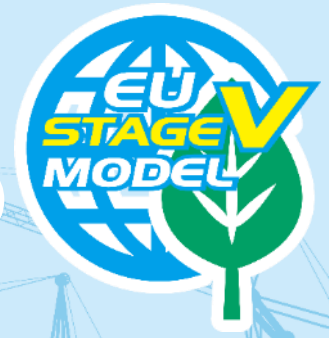

**MANUAL & AUTO - START GENERATOR
CONTROLLER (DSE 7310MK II)**



Control Panel with Outstanding Usability

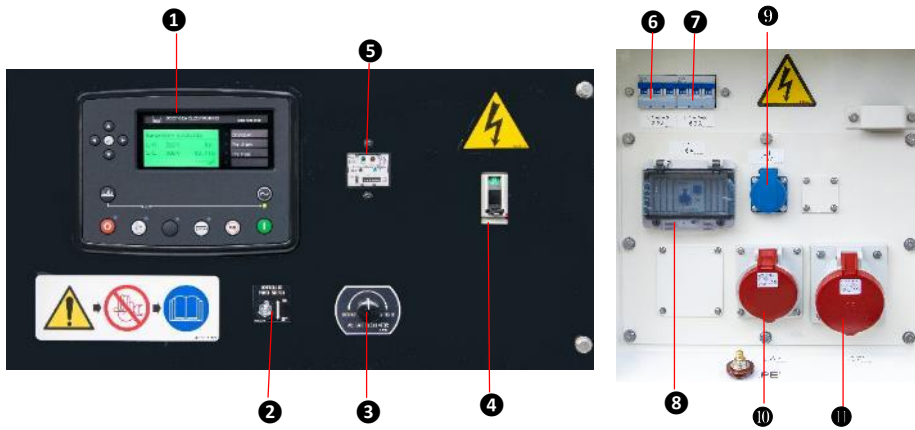

- ① MANUAL & AUTO – START GENERATOR CONTROLLER (DSE 7310MK II)
- ② CONTROL POWER SWITCH
- ③ VOLTAGE REGULATOR
- ④ Circuit Breaker (For main)
- ⑤ EARTH LEAKAGE RELAY
- ⑥ CIRCUIT BREAKER (For 3-Phase Receptacle 32A)
- ⑦ CIRCUIT BREAKER (For 3-Phase Receptacle 63A)
- ⑧ CIRCUIT BREAKER (For 1-Phase Receptacle 16A)
- ⑨ 1-PHASE RECEPTACLE (16A)
- ⑩ 3-PHASE RECEPTACLE(32A)
- ⑪ 3-PHASE RECEPTACLE (63A)

Easy Access and Service

-Routine maintenance is easy with DCA-41ESEK5. The radiator can also be cleaned easily.

-Swivel-type oil drain increases the speed of draining compared to conventional type.



Swivel-type oil drain



Eco Friendly

•Compliant with the EU's Emission Regulation 2016/1628 (Stage-V).

•An environmental base catches spilled fuel and oil and stop it from leaking out of the generator (accumulated fuel and oil can be discharged through a drain with a single touch).



The filling structure prevents fuel leakage from generator even if spilled while fueling.



Safety

- 4 Pole Main Circuit Breakers
- Warning lamp indicates on the generator controller when something is wrong or automatically shuts the engine down.
- Engine shuts down when door opens.
- Emergency stop button.



Options

- Forklift Pocket Base
- Big Tank for 24 hours operation
- Battery Switch
- Customized Color
- *About other options, please consult

MODEL	3-PHASE TYPE (Sound Proof)
	DCA-41ESEK5

AC Generator

Frequency	Hz	50
Output Rating kVA	Prime	37
	Standby	40.7
No. of Poles		4
No. of Phases		3
Rated Voltage	V	380/400/415
Power Factor		0.8(Lagging)
Voltage Regulation	%	Within ± 0.5
Excitation		Brushless rotating exciter (with AVR)
Insulation		Class F

Engine(4-cycle,water-cooled diesel engine)

Model	KUBOTA V3800	
Type	Direct injection, cooled EGR, turbocharged	
Rated Output	kW	38.9
Rated Speed	min ⁻¹	1500
No.of Cylinders		4
Bore x Stroke	mm	100 x 120
Displacement	L	3.769
Fuel	ASTM No.2 diesel fuel or equivalent	
Fuel tank Capacity	L	110
Fuel Consumption	L/h	6.8
Lube Oil Capacity	L	12
Coolant Capacity	L	10
Battery×Quantity	115D31R×1	

Dimensions, Weight and Sound Power Level

Dimensions	Length	mm	2015
	Width	mm	940
	Height	mm	1670
Dry Weight		Kg	1220
Sound Power Level	LwA	dB	88

- Prime output rating applicable for an unlimited number of annual operating hours in variable load applications in accordance with ISO8528-1
- Standby output rating applicable for supplying emergency power in variable load applications in accordance with ISO8528-1
- Fuel consumption is based on operation at 75% load.
- Sound power level (LwA) is at 50Hz 75% Prime power.
- Colors of products would be different from printed ones of catalogues.
- Specifications given herein are subject to change without notice.

-In line with our policy of continuous development, we reserve the right to change specification without notice.

-Always follow the Operation Manual when storing, transporting, and operating the machine.

 **Denyo Europe B.V.**

Naamrijk 1,3454 PX De Meern, The Netherlands

Tel: 31-30-666-8314 Fax: 31-30-662-2150

<http://www.denyo.co.jp/group/europe>